

A

SITE PLAN
1" = 20'-0"

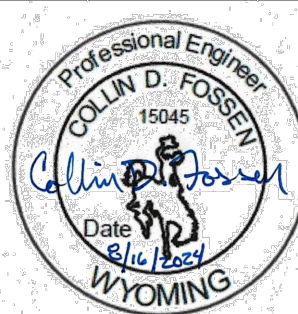

REVISION: REV-1 08-16-24

DATE: 5-23-2024
JOB: 22-3262
SHEET NO.:

C1.0

GENERAL NOTES:

1. CIVIL SITE WORK AND UTILITY INSTALLATION SHALL FOLLOW WYOMING PUBLIC WORKS 2015 STANDARD SPECIFICATIONS WITH CITY OF LARAMIE PROVISIONS AND STANDARD DETAILS.
2. BACKFILL AND PREPARATION UNDER FOUNDATIONS SHALL FOLLOW RECOMMENDATIONS FROM THE GEOTECHNICAL REPORT (PROJECT NO. 24245022) PREPARED BY TERRACON DATED June 10, 2024
3. NEW CURB AND GUTTER ON SITE SHALL BE CITY OF LARAMIE ROLL-OVER CURB.

4. PARKING LOT STRIPING SHALL BE 4' WIDE STRIPES USING WHITE PAINT PER LMC 15.14.040.C.11.C

Rev 1

Approximate Cut/Fill Quantities

To bottom of sub grade

Cut	6500 Cubic Yards
Fill	4800 Cubic Yards

Approximate Road Base Fill Req

Fill	1300 Cubic Yards
------	------------------

Approximate Asphalt Quantity

	2950 Square Yards
--	-------------------

TYPICAL CROSS SECTION FOR SITE SURFACING

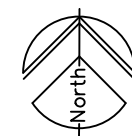
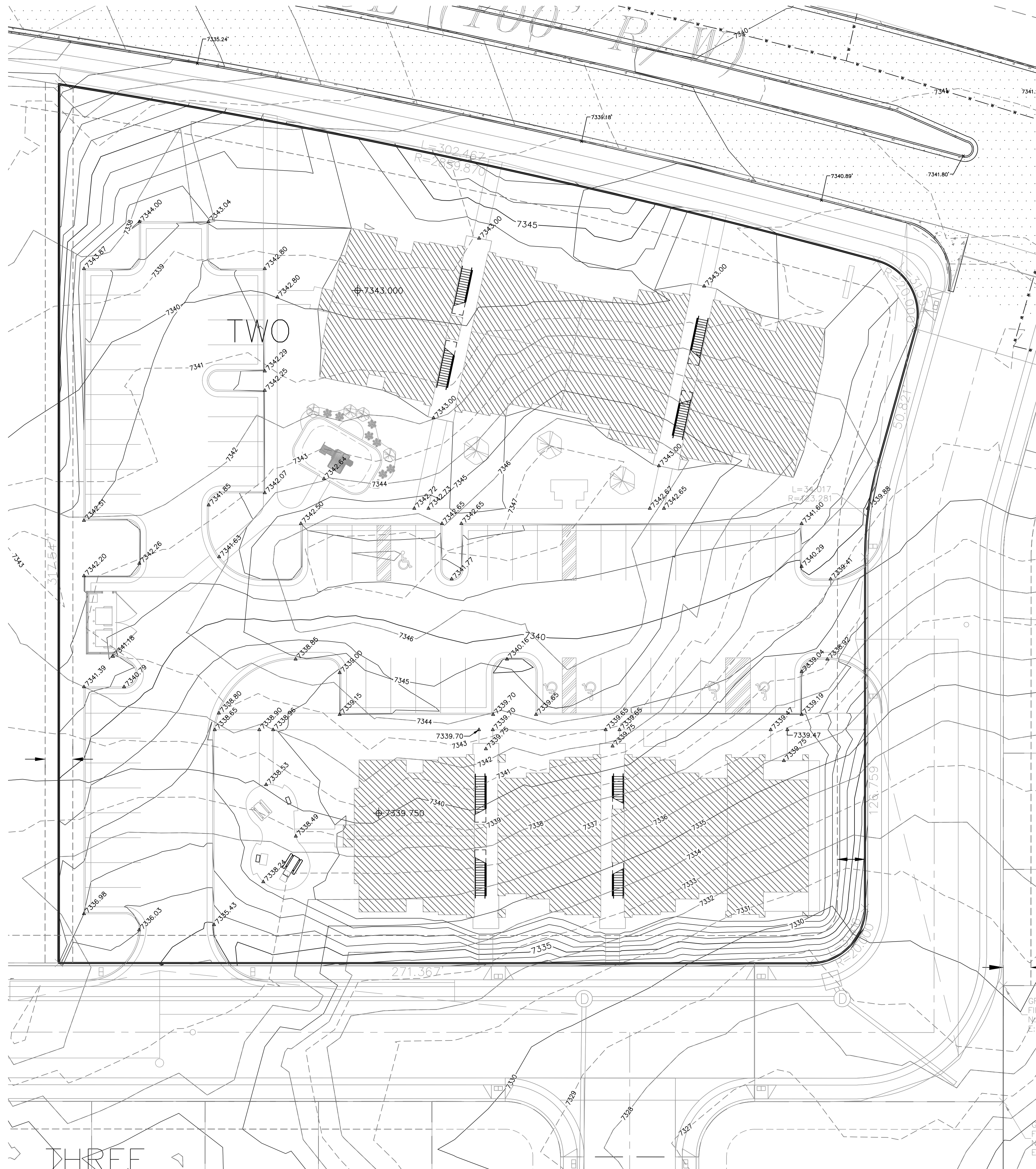
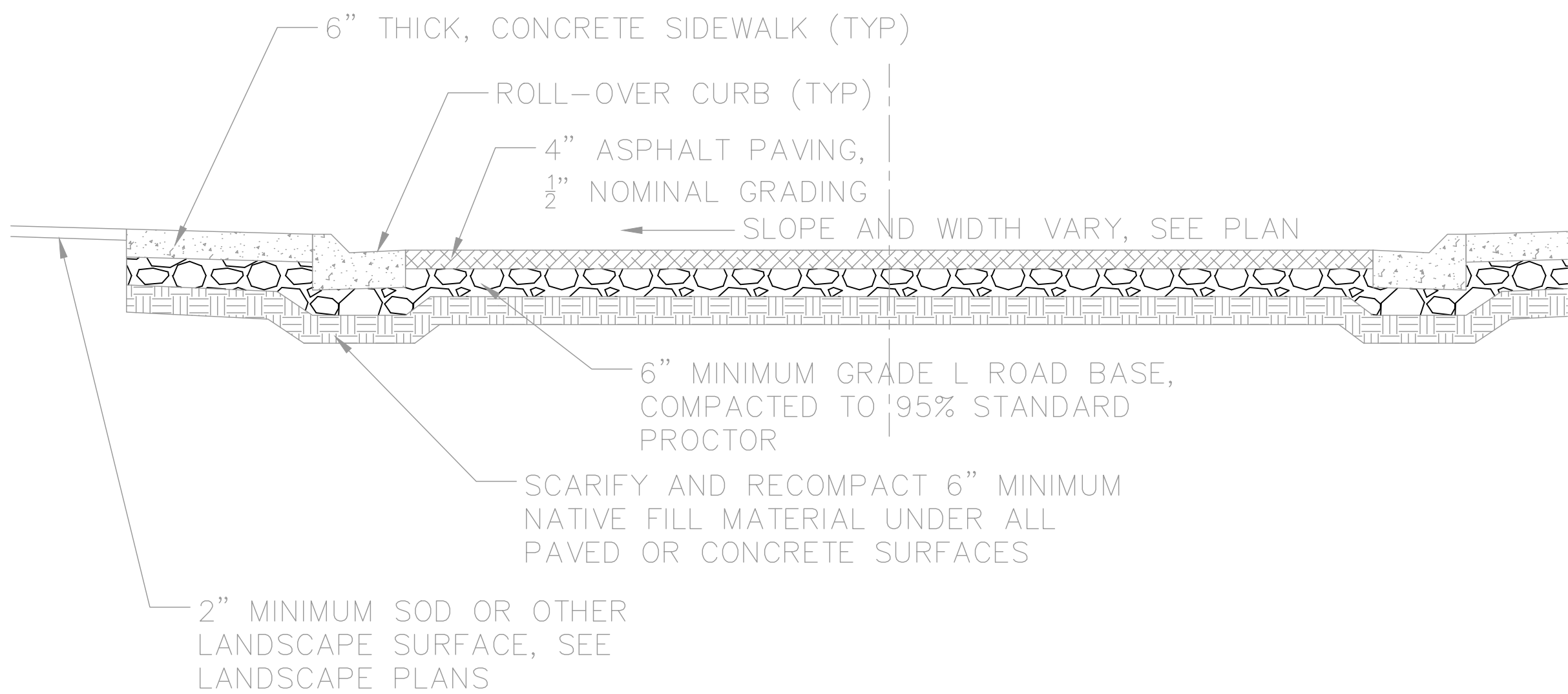

C

GRADING PLAN

1" = 20'-0"

THE RESERVES AT GRAND VIEW HEIGHTS

NEW APARTMENT COMPLEX

LARAMIE,

WYOMING

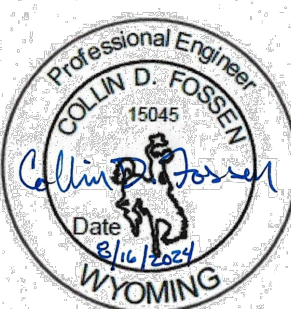

REVISION: REV-1 08-16-24

DATE:	5-23-2024
JOB:	22-3262
SHEET NO.:	

C2.0

COPYRIGHTED ©

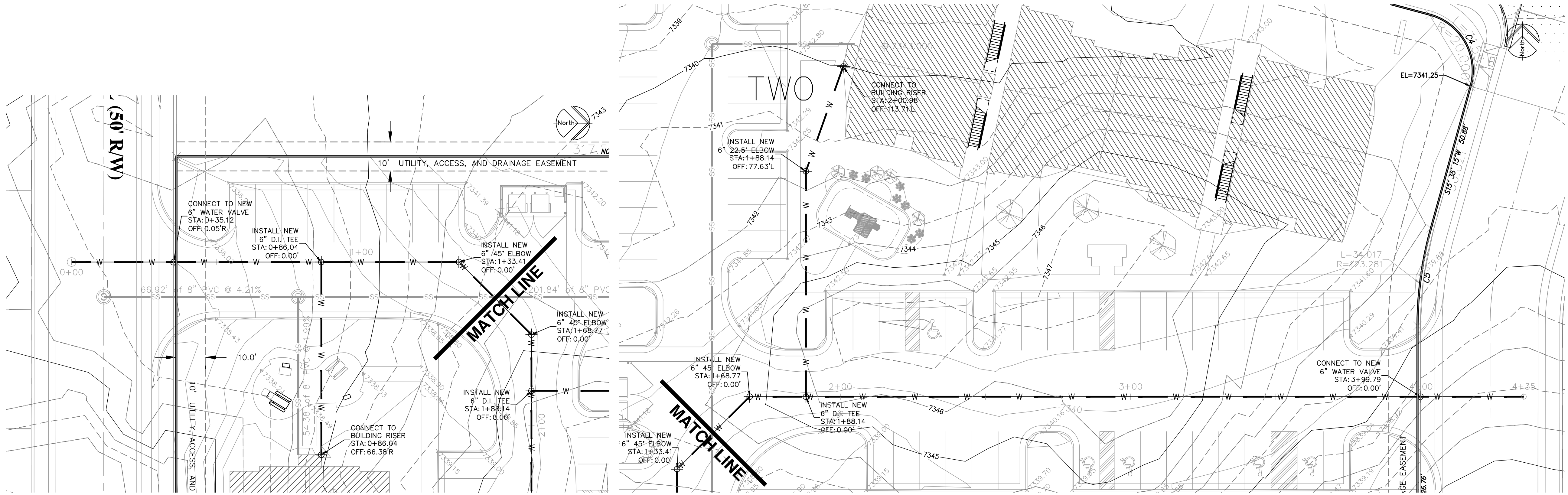

Alignment – WATER PROFILE

